

HOW TO CONNECT TO THE MOBILE APP - GUARD VIEWER / GUARD LIVE

The NVR must be successfully connected to your network before you set up the mobile application.

Download the app. Guard viewer or Guard live

Register for an account

Click **Sign up**

Enter your email address.

Click on the bubble once you have read

and agree with the privacy policies.

Click on **Verify**.

A verification code will be sent to the email address used to register the app.

Check that email address to retrieve the verification code. Enter it into the app.

Click **Next**.

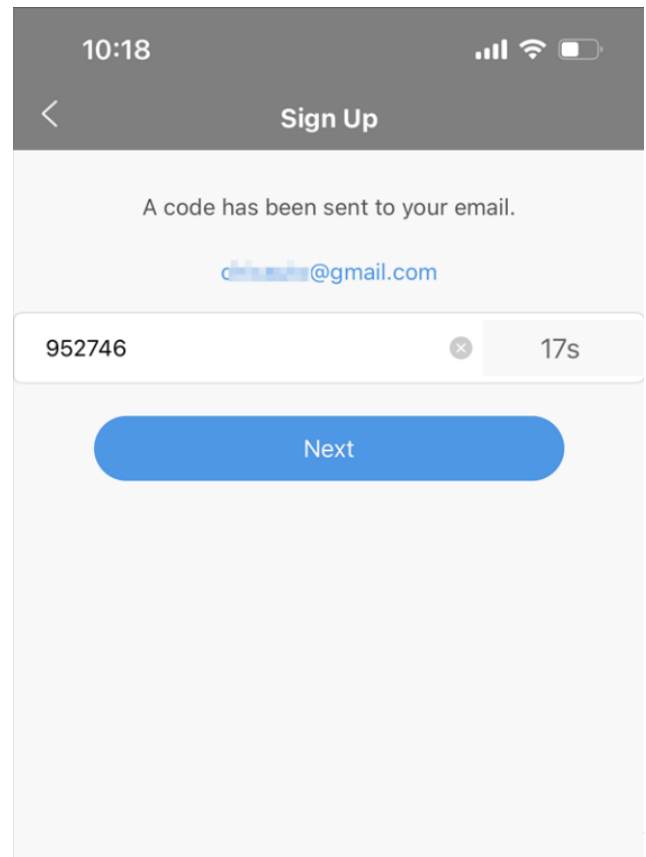
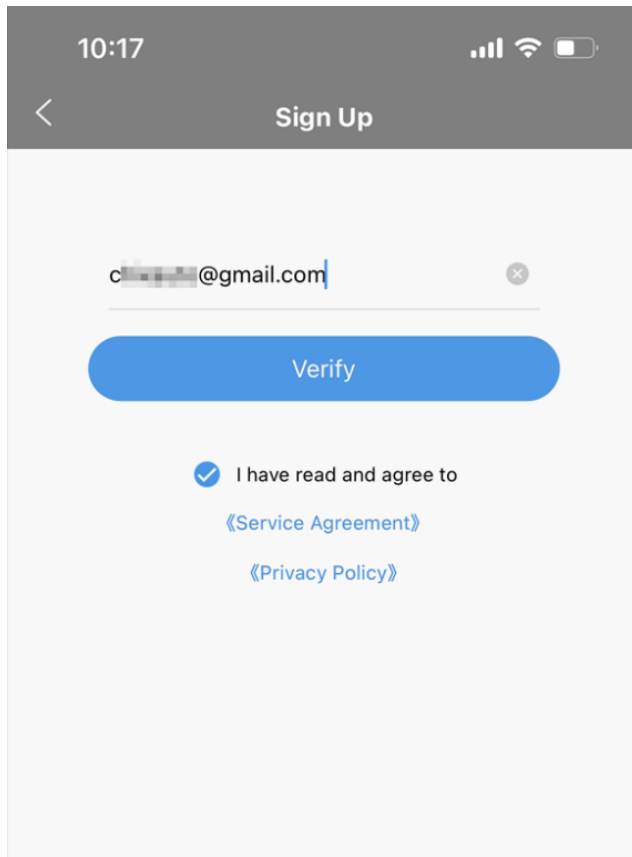
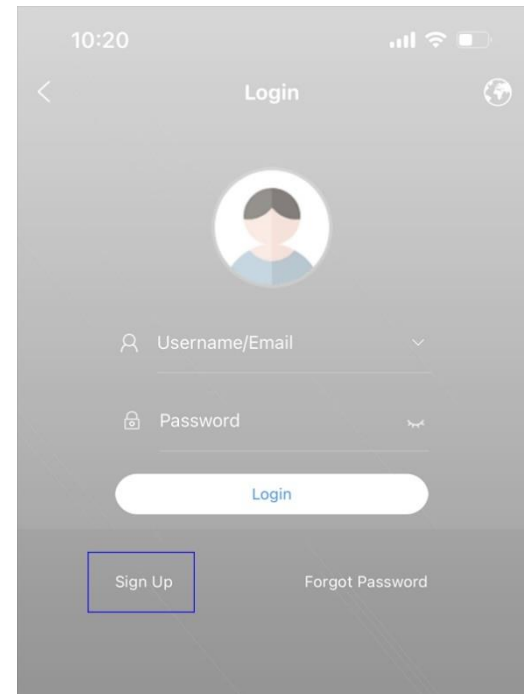

Create a password for the mobile app account.
Click **Sign-up**.

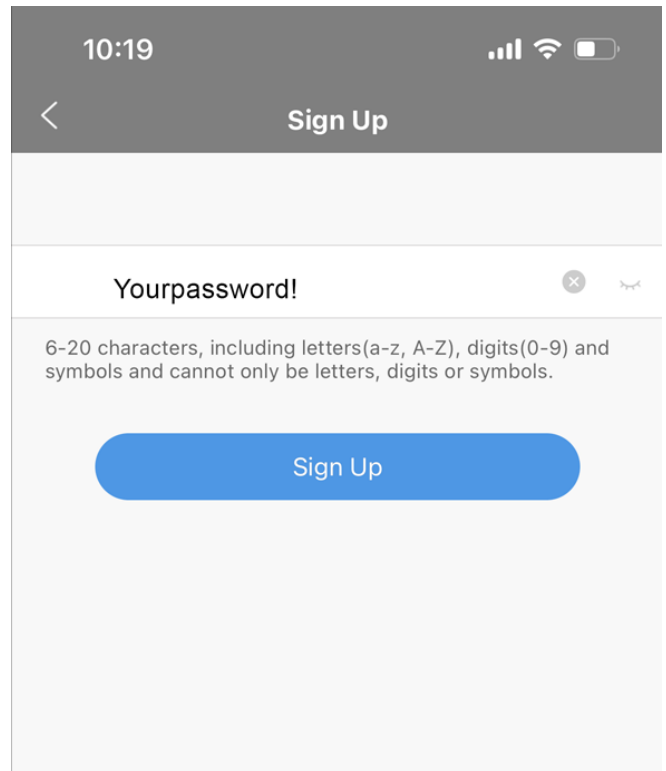

To add the NVR to the app, you need to bring up the QR code in the NVR settings.

Log in to the NVR.

Right click the mouse anywhere on the screen.

Click on **Menu**.

Click on **Network**.

Click on **P2P**.

Click to check the box to **Enable P2P** if it is not already checked. Click **Apply**.

Device status must show **Network Connected** before you can connect the NVR with the app.

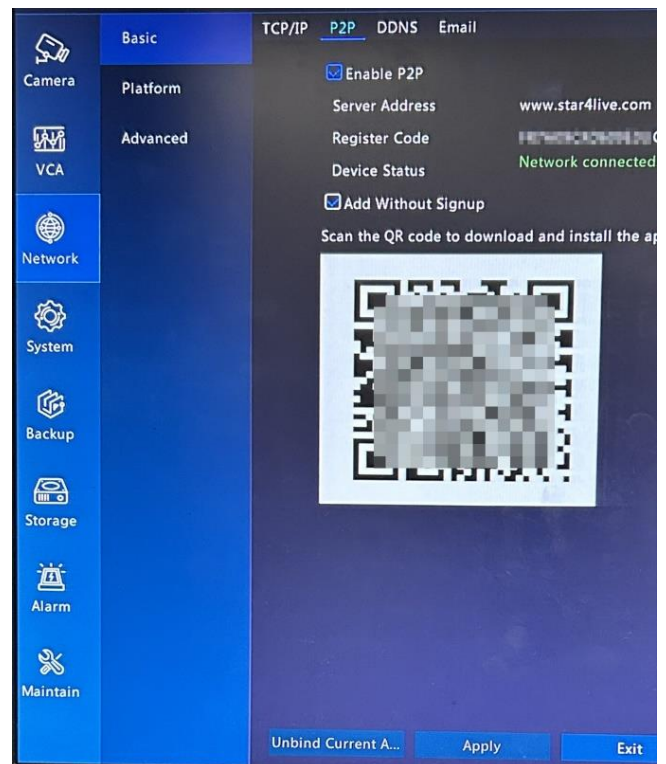

Reopen the application on your phone.

Tap the **3 stacked lines** icon.

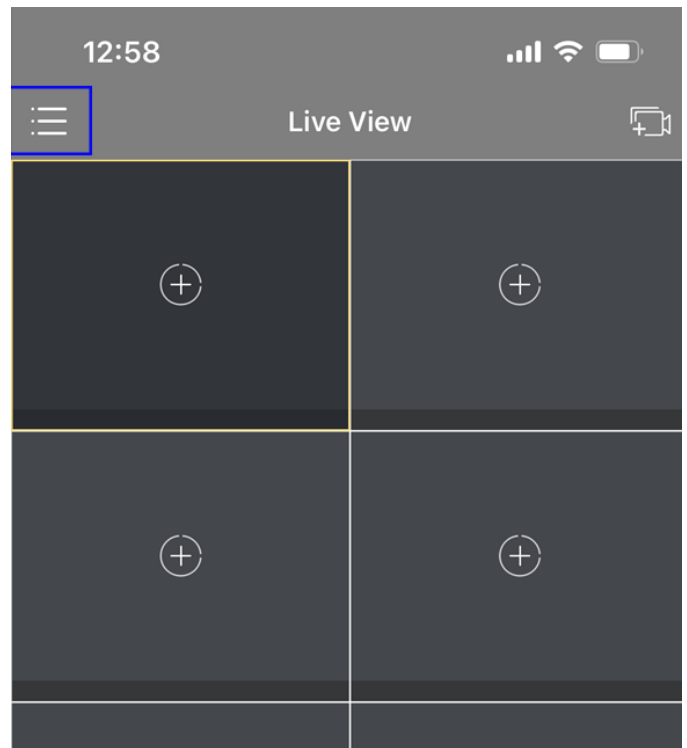

Tap on **Devices**.

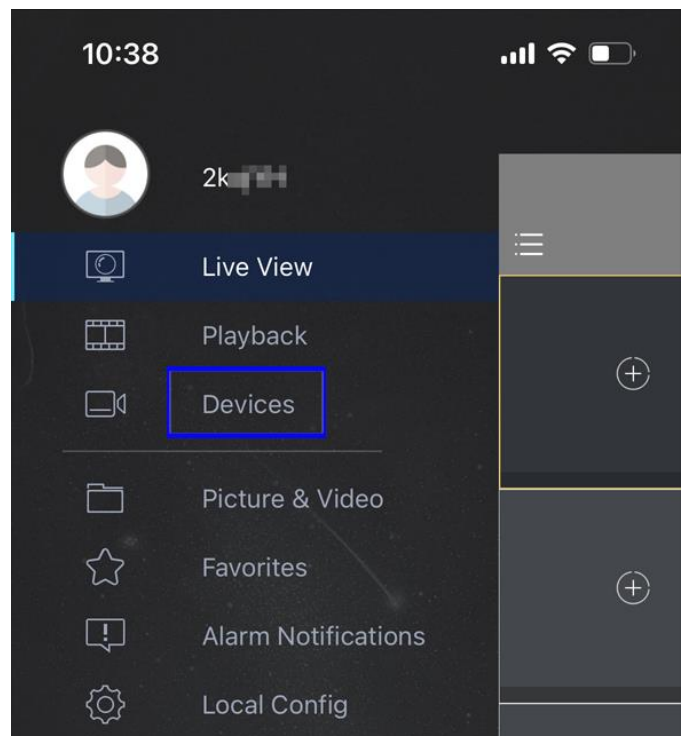

Tap **+Add**.

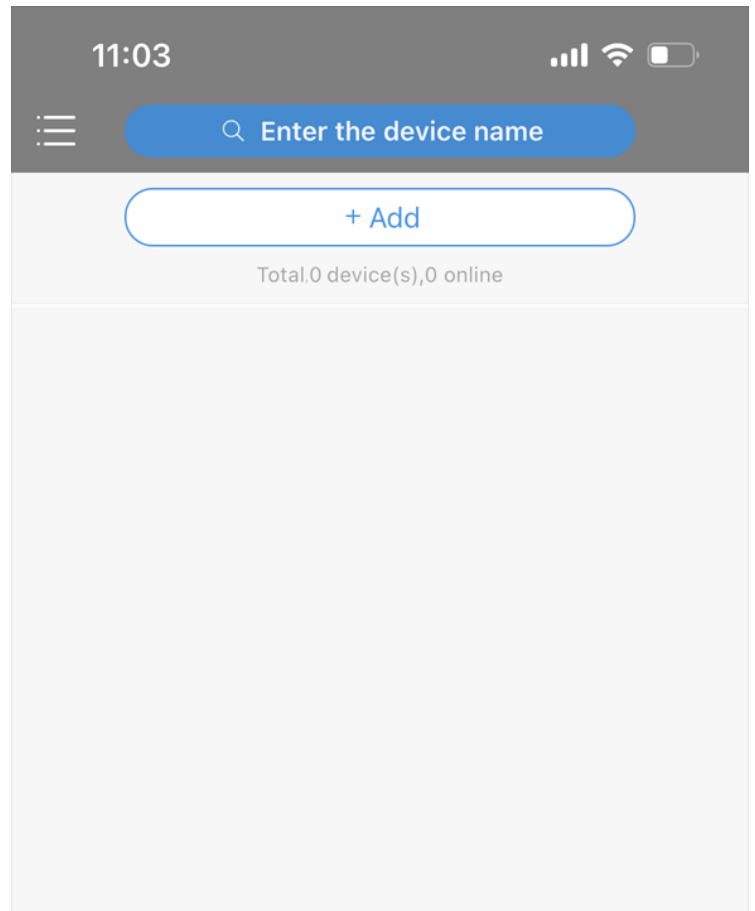

Tap **Scan**.

The QR code scanner will open in the app. Aim your cell phone at the QR code displayed in the NVR network settings P2P page.

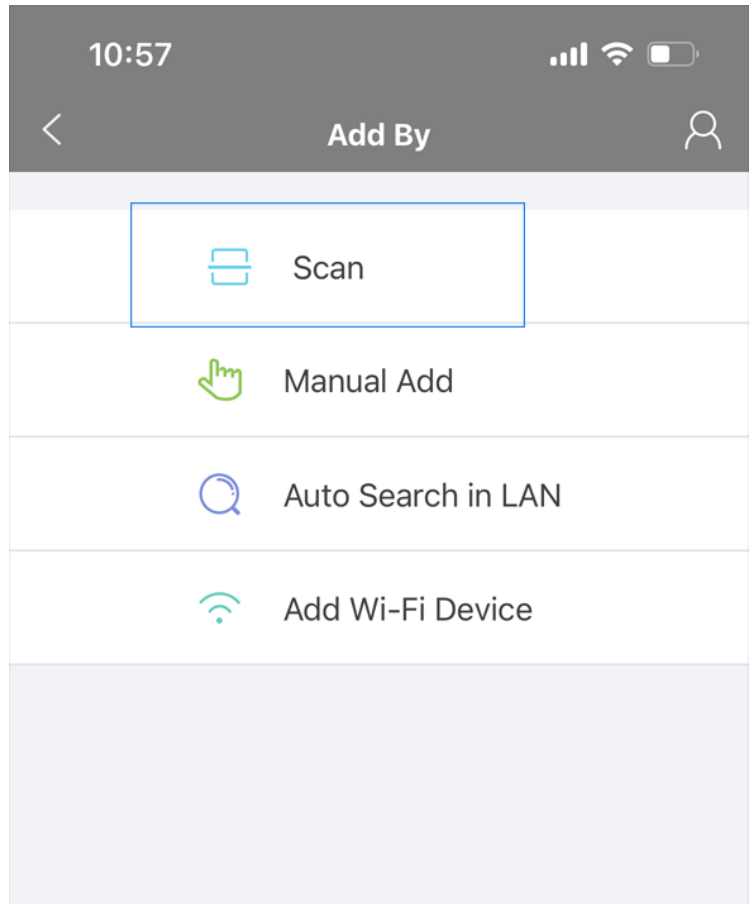

Once the app captures the QR code type in a name for the NVR. You can name it anything you like.

Tap on **Start Live View**

